

*American Standard*

**Serin®**  
**Flash™ 2-Handle Integrated Diverter**  
**Pressure Balance Valve Trim**

MODEL NUMBERS

**TU064740**

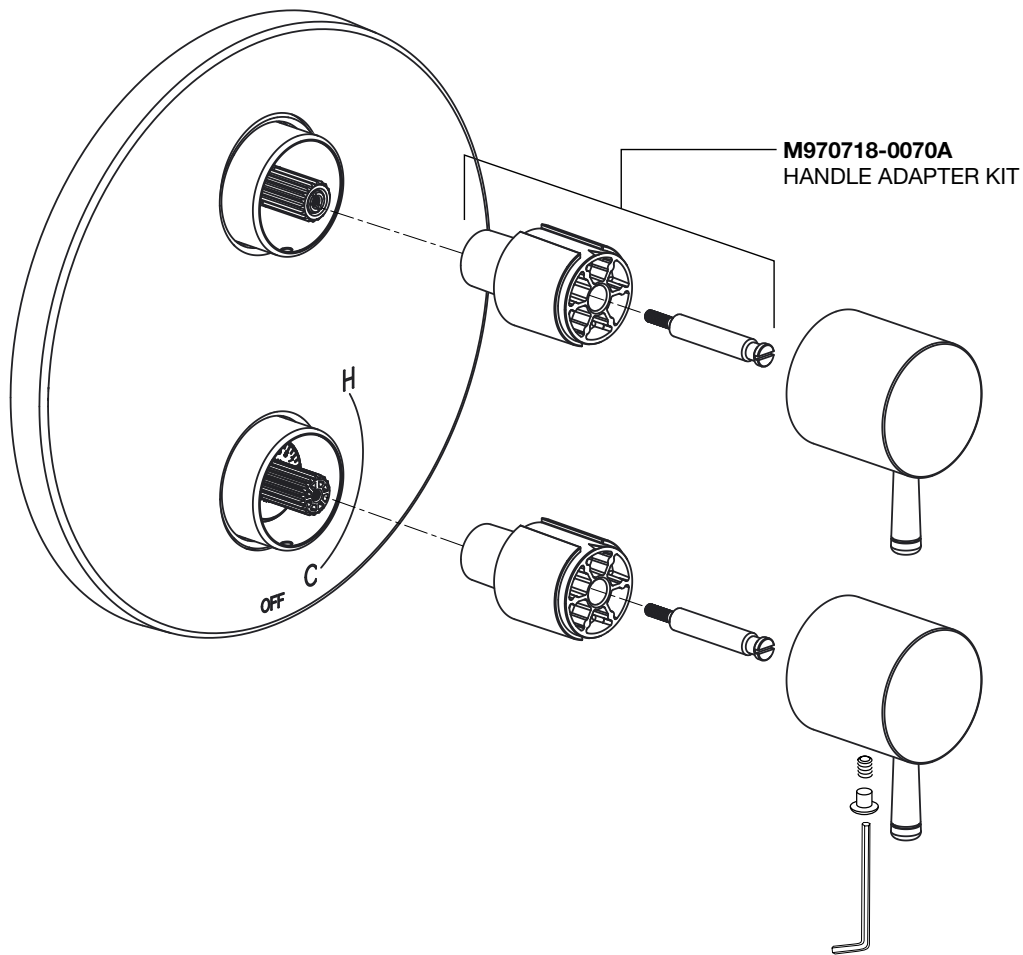

Replace the "YYY" with appropriate finish code

POLISHED CHROME	002
BRUSHED NICKEL	295

**HOT LINE FOR HELP**

For toll-free information and answers to your questions, call:  
1 (800) 442-1902

Mon. - Fri. 8:00 a.m. to 8:00 p.m. EST  
Saturday 10:00 a.m. to 4:00 p.m. EST

IN CANADA 1-800-387-0369  
(TORONTO 1-905-306-1093)

Weekdays 8:00 a.m. to 7:00 p.m. EST

IN MEXICO 01-800-839-1200



PART OF **LIXIL**