

*American Standard*

# INSTALLATION INSTRUCTIONS

## FLUENT® DECK MOUNT BATH FILLER

7186.900  
7186.901

*Thank you for selecting American Standard...  
the benchmark of fine quality for over 140 years.*

**To ensure that your installation proceeds smoothly-please read  
these instructions carefully before you begin.**



Certified to comply with ANSI A112.18.1M

### RECOMMENDED TOOLS



Phillips Screwdriver



Channel Locks



Adjustable Wrench



Flat Blade Screwdriver



Hex Wrench  
(supplied)

### ROUGHING-IN DIMENSIONS

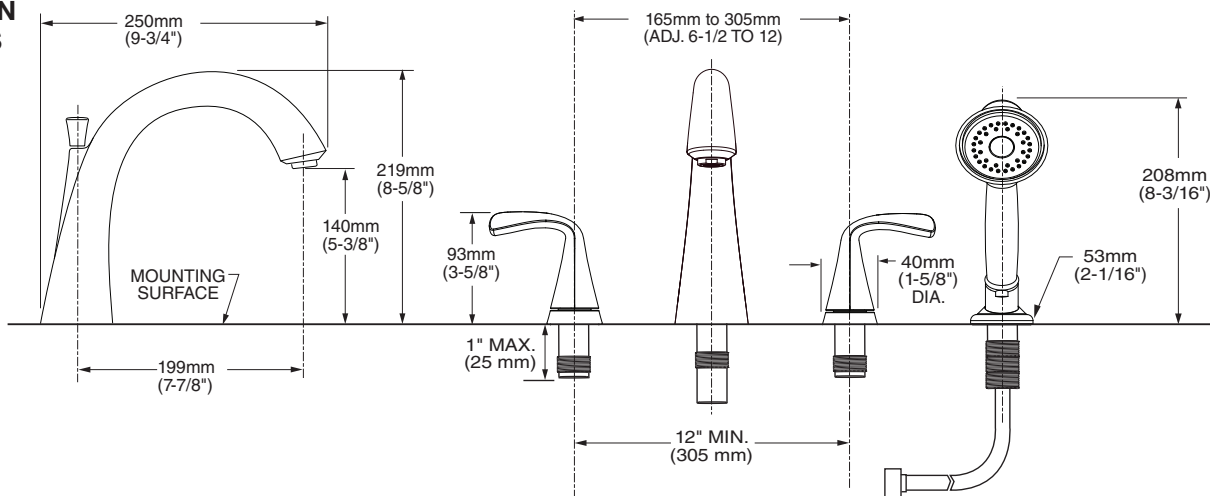

### 1 INSTALL SPOUT

#### CAUTION

Turn off hot and cold water  
supplies before beginning.

- Thread DIVERter INSERT (5) carefully it touches the installation surface, be sure the RUBBER RING (4) is properly seated in it's RECESS at the base of the SPOUT (1).
- Thread SET SCREW (3) using 5 mm hex wrench supplied. Make certain SET SCREW (3) is properly aligned and tight so that SPOUT (1) is locked in place.
- Install PLUG BUTTON (2).

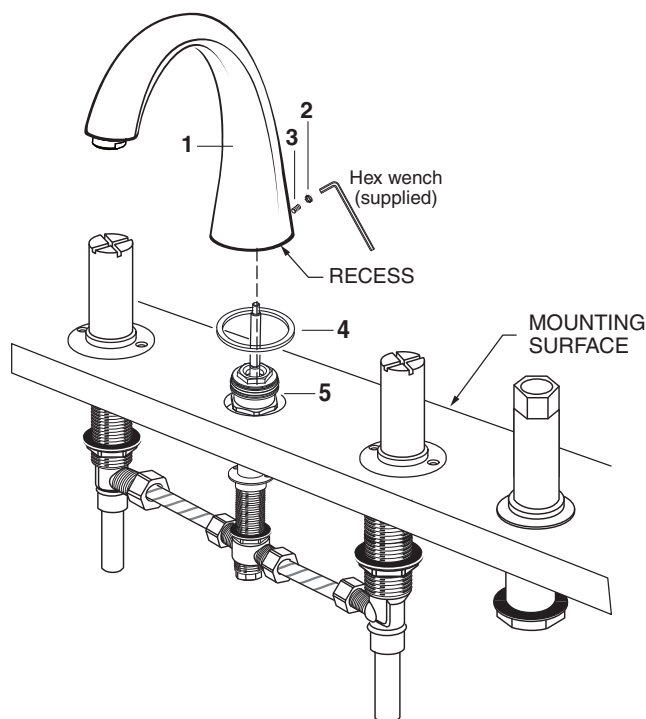

## 2 VALVE ASSEMBLY

- Remove PLASTER GUARDS.
- Thread INSERT (1) into SIDE VALVE (2) until it touches the installation surface.
- Thread INSERT (3) into SIDE VALVE (4) until it touches the installation surface.
- Tighten COUPLING (5) into TEE (6) for products without hand shower.

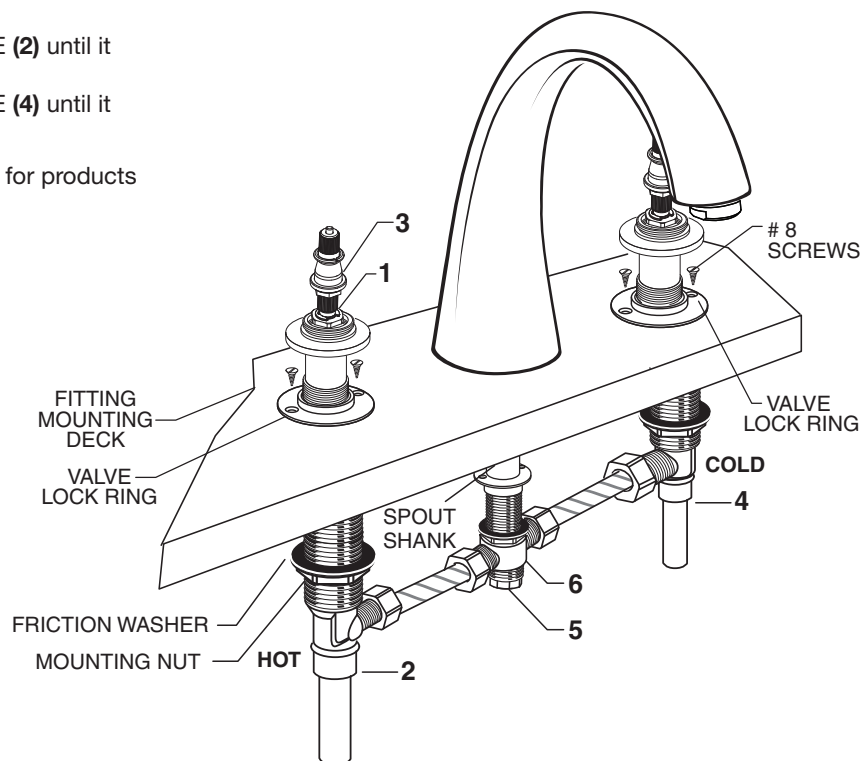

## 3 INSTALL HANDLES

- Turn VALVE to OFF position.
- Push ADAPTER (1) on VALVE STEM (2), so that the hole of the ADAPTER (1) without a spline is facing up. **Fig. A.** Tighten STEM SCREW (3) to secure ADAPTER (1).
- Align DECK ADAPTER (5) to LEVER HANDLE ASSEMBLY (4). Push LEVER HANDLE ASSEMBLY (4) onto DECK ADAPTER (5) firmly to flush against mounting surface.

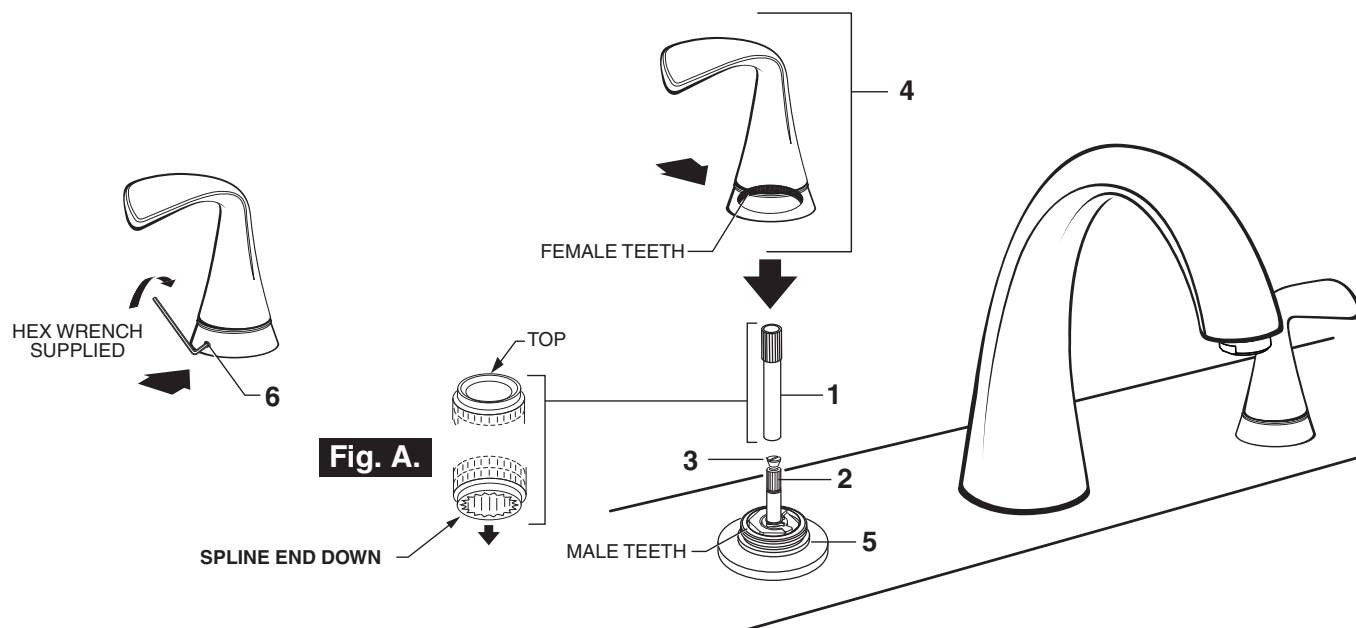

## 4 HAND SHOWER INSTALLATION

- Install RUBBER RING (2) on SPRAY ESCUTCHEON (1) and install SPRAY ESCUTCHEON (1) through fifth hole on tub ledge (12" max from Spout) making sure the SPRAY ESCUTCHEON (1) opening is directed toward tub center. Install RUBBER WASHER (3), BRASS WASHER (3a) and LOCKNUT (4) from underside of ledge. Be sure RUBBER RING (2) is properly seated in ESCUTCHEON (1). Install RUBBER WASHER (3) and LOCKNUT (4) from underside of ledge.
- Secure SPRAY ESCUTCHEON (1) by tightening LOCKNUT (4).
- Slip SHOWER HOSE (7) with HOSE CONNECTOR through SPRAY HOLDER (5) and ESCUTCHEON (1) from above deck. **Note:** SPRAY HOLDER (5) must be separate from ESCUTCHEON (1) to get SPRAY HOSE (7) through ESCUTCHEON (1). Make sure threads on SPRAY HOLDER (5) are facing the SPRAY ESCUTCHEON (1). Install CHECK VALVE (11) and SEAL (8) on SPRAY HOSE (7) and connect HOSE (10) to SPRAY HOSE (7). Install SEAL (8) on SPRAY HOSE (7) at HAND SHOWER (9) connection and connect HAND SHOWER (9) to SPRAY HOSE (7).

**NOTE:** When not in use, HAND SHOWER should be seated in the HOLDER.

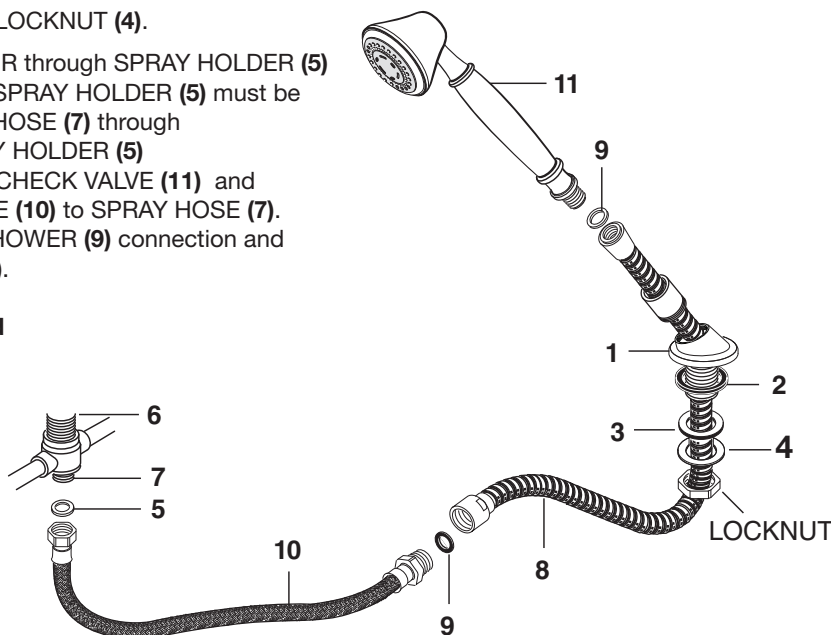

## 5 SERVICE

To change direction of handle rotation, proceed as follows:

- Turn valve to OFF position. Unthread HANDLE BASE (1) from DECK ADAPTER (2).
- Pull HANDLE ASSEMBLY off VALVE STEM (3).
- Remove SPRING CLIP (4). Lift STOP WASHER (5), turn 90° and replace. Replace SPRING CLIP (4).
- Find correct position of HANDLE ASSEMBLY by adjusting male teeth on VALVE STEM (3) to female teeth in HANDLE.
- Thread HANDLE ASSEMBLY onto DECK ADAPTER (2) until snug against mounting surface.

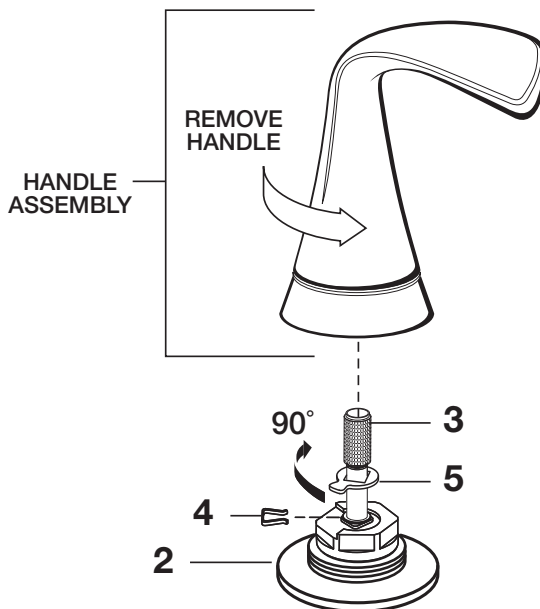

## 6 CARE INSTRUCTIONS:

**DO:** SIMPLY RINSE THE PRODUCT CLEAN WITH CLEAR WATER. DRY WITH A SOFT COTTON FLANNEL CLOTH.

**DO NOT:** DO NOT CLEAN THE PRODUCT WITH SOAPS, ACID, POLISH, ABRASIVES, HARSH CLEANERS, OR A CLOTH WITH A COARSE SURFACE.

# American Standard

## FLUENT® DECK MOUNT BATH FILLER

MODEL NUMBER

**7186.900**  
**7186.901**

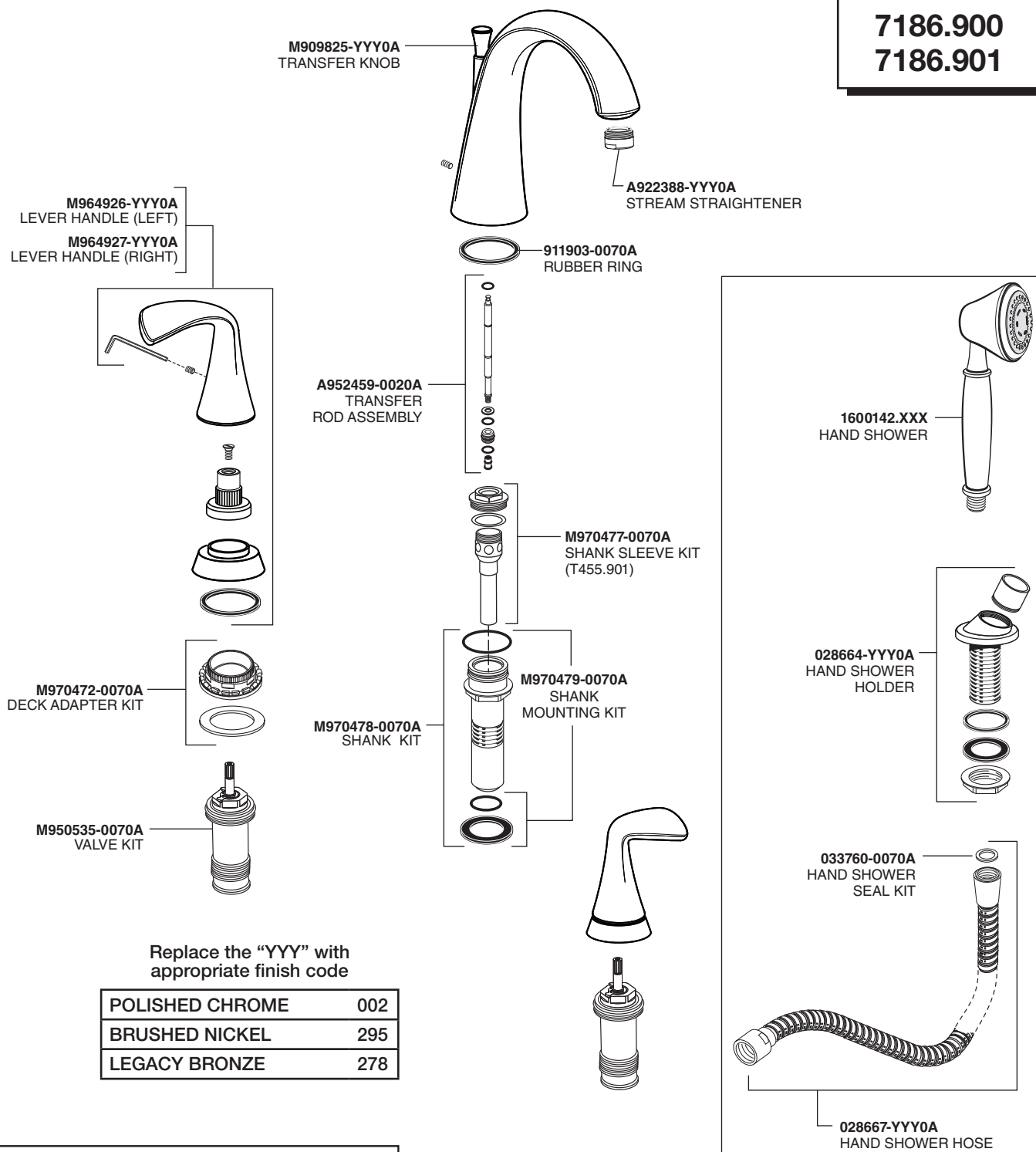

### HOT LINE FOR HELP

For toll-free information and answers to your questions, call:

1 (800) 442-1902

Mon. - Fri. 8:00 a.m. to 8:00 p.m. EST

Saturday 10:00 a.m. to 4:00 p.m. EST

IN CANADA 1-800-387-0369

(TORONTO 1-905-306-1093)

Weekdays 8:00 a.m. to 7:00 p.m. EST

IN MEXICO 01-800-839-1200



PART OF **LIXIL**