

# INSTALLATION INSTRUCTIONS R850 SERIES

## DECK MOUNT TUB SYSTEMS ROUGH VALVE KIT

Thank you for selecting American-Standard...  
the benchmark of fine quality for over 100 years.

To ensure that your installation proceeds smoothly-please read  
these instructions carefully before you begin.

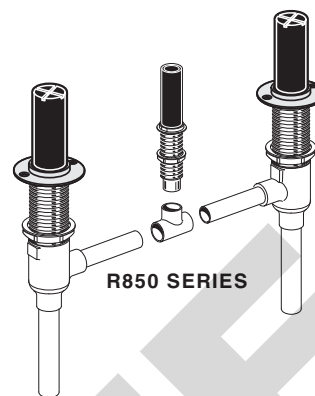

Certified to comply with ANSI A112.18.1  
U.S. Patent No. D403,750

### 1 ROUGHING-IN

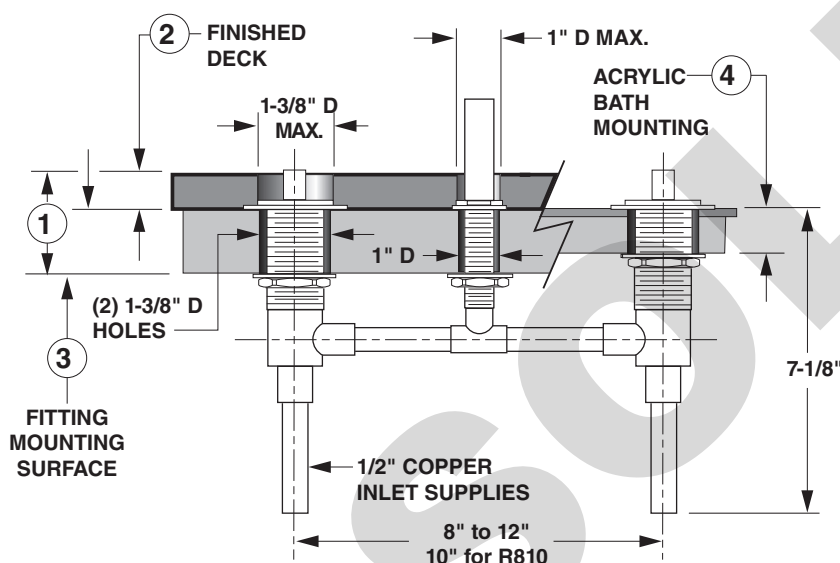

1. **DECK THICKNESS**  
TOTAL DECK THICKNESS UP TO 2-1/2"
  2. **FINISHED DECK**  
FINISHED DECK VARIABILITY ACCOMMODATES  
DECKING MATERIAL (TILE, MARBLE, CORIAN®...) TO 1" THICK
  3. **FITTING MOUNTING SURFACE**  
ADJUSTABILITY, TO 1-1/2" THICK
  4. **ACRYLIC BATHS**  
ADJUSTABILITY, TO 1-1/2" THICK
- DECK MOUNTING HOLES
- 8" to 12"  
10" for R810

### 2 MOUNT SPOUT SHANK

- Drill holes in mounting deck as shown. The maximum allowable deck thickness is 1-1/2".
- Insert the SPOUT SHANK through the mounting deck from below. Assemble the SPOUT SHANK LOCK RING so it is flush with the top of the threads on the SHANK.

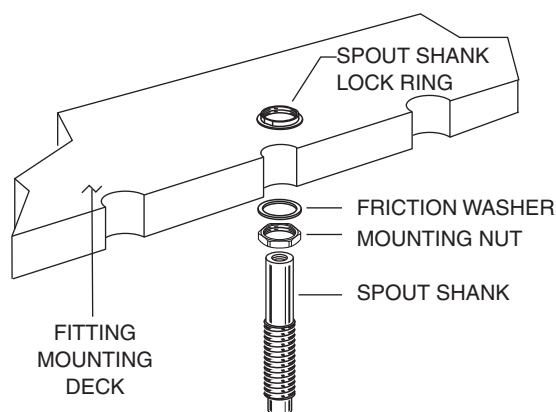
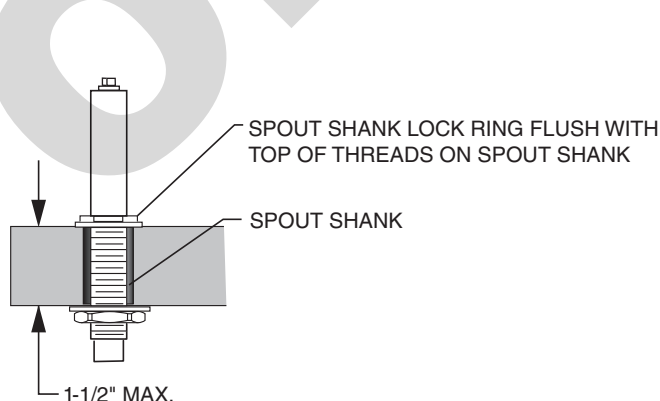

### 3 MOUNT VALVE BODIES

- Cut the copper outlet tubes of the VALVE BODIES as required. (Not necessary for R810).
- Insert the HOT and COLD VALVE BODIES into the TEE. (Not necessary for R810). The HOT VALVE BODY is marked with a red label.
- Insert the VALVE BODIES and TEE through the mounting deck from below. Assemble the VALVE LOCK RINGS so they are flush with the top of the VALVE BODIES.
- Insert the SPOUT SHANK into the TEE. (Not necessary for R810).
- Tighten the VALVE BODY and SHANK MOUNTING NUTS securely.
- Cap off shower pipe (5) and tub filler pipe (6).
- Fasten the VALVE LOCK RING to the wooden mounting surface with #8 screws (not provided).

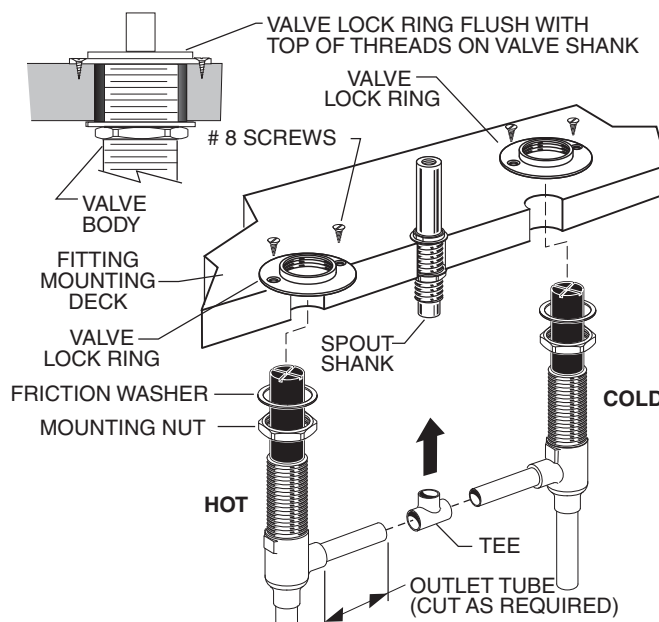

### 4 SOLDER CONNECTIONS

- Connect the water supply lines to the copper inlet tubes of the VALVE BODY.
- Solder all TEE and WATER SUPPLY CONNECTIONS.
- Remove the GUARD from the SPOUT SHANK. Assemble the 1/4" PLUG to the SPOUT SHANK with a thread sealant.
- Turn on the water supplies and check all connections for leakage.
- Replace the GUARD on the SPOUT SHANK. Turn off the water supplies.

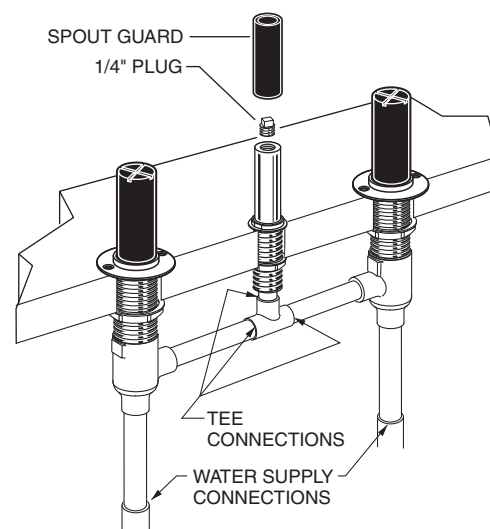

### 5 SERVICE – TO CHANGE THE DIRECTION OF HANDLE ROTATION

- Turn off the water supplies.
- Turn HANDLE to the off position.
- Unscrew the VALVE LOCK NUT and remove. An 17 mm deep socket is required.
- Remove the CARTRIDGE by pulling upon the SLEEVE.
- Remove the SLEEVE from the CARTRIDGE.
- Remove the SPRING CLIP.
- Remove the STOP WASHER. Turn it 90° and replace.
- Replace the SPRING CLIP.
- Reverse the above steps to reassembly the components.
- If the spout drips, operate the handles several times from the off to the on position. Do not force - the handles only turn 90°

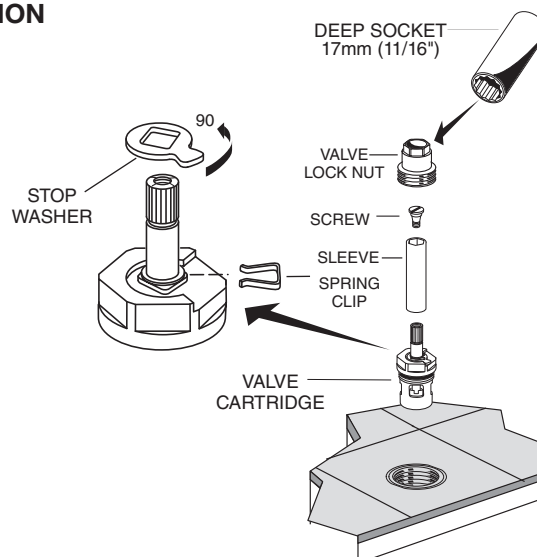

# American Standard

## DECK MOUNT TUB SYSTEMS ROUGH VALVE KIT

MODEL NUMBERS

**R850 SERIES**

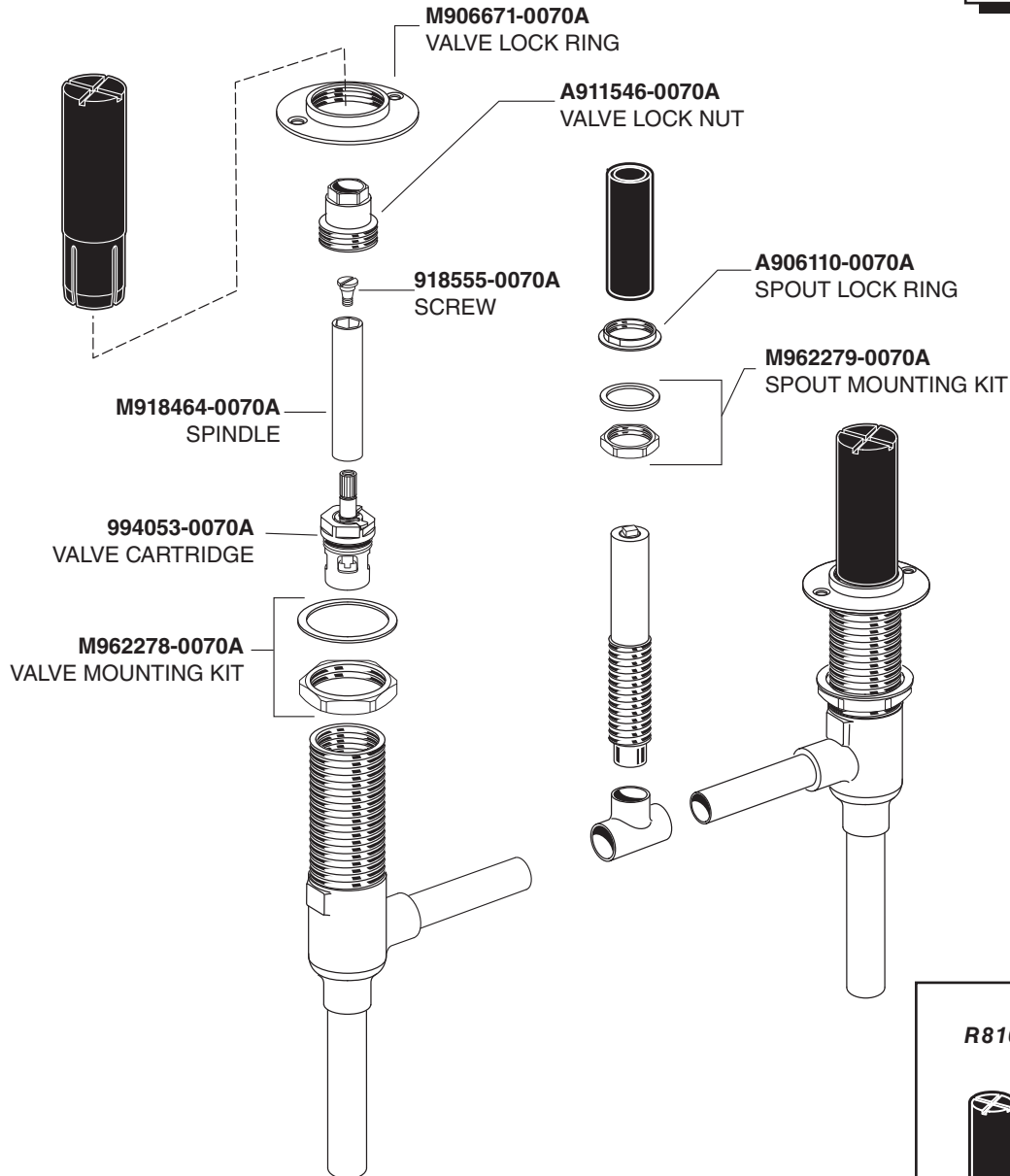

### HOT LINE FOR HELP

For toll-free information and answers to your questions, call:  
1 (800) 442-1902

Weekdays 8:00 a.m. to 6:00 p.m. EST

IN CANADA 1-800-387-0369

(TORONTO 1-905-306-1093)

Weekdays 8:00 a.m. to 7:00 p.m. EST

IN MEXICO 01-800-839-1200



PART OF **LIXIL**

### R810 SERIES

