

# INSTALLATION INSTRUCTIONS

## REMOVABLE TOILET SEAT

*American Standard*

Thank you for selecting American Standard – the benchmark of fine quality for over 100 years. To ensure this product is installed properly, please read these instructions carefully before you begin. (Certain installations may require professional help.) Also be sure your installation conforms to local codes.

### BOTTOM MOUNT TOILET SEAT

**NOTE:** Pictures may not exactly depict toilet seat and components.

**1**

Install rubber base to seat post hinges.

**2**

Slip the bolts through the washers, then through the hinge holes.

**3**

**TANK**

**OR**

**FRONT OF BOWL**

The hinge features built-in adjustable washers. Rotate washers as needed for the best alignment of the seat on the toilet bowl.

**4**

Thread the nuts onto the bolts. Tighten the bolts using a screwdriver. **DO NOT OVERTIGHTEN.**

**5**

Close the hinge covers. The seat will not work if the hinge covers are not closed tightly.

**SNAP-OFF INSTRUCTIONS**

**1**

Open the hinge covers.

**2**

Slide seat forward to remove seat from posts.

**SNAP-ON INSTRUCTIONS**

**1**

Slide seat onto seat posts.

**2**

Close the hinge covers.



Product names listed herein are trademarks of AS America, Inc.  
© AS America, Inc. 2015

760132-100 Rev. F 6/15

SAVE FOR FUTURE USE

# BOTTOM MOUNT ZIP SPEED CONNECT TOILET SEAT NOTE: Pictures may not exactly depict toilet seat and components.

## ASSEMBLY

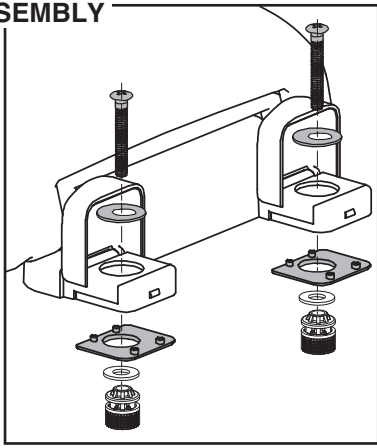

1

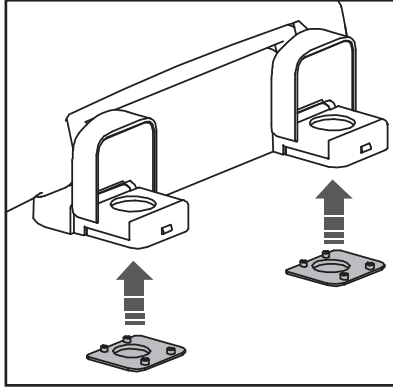

Install rubber base to seat post hinges.

2

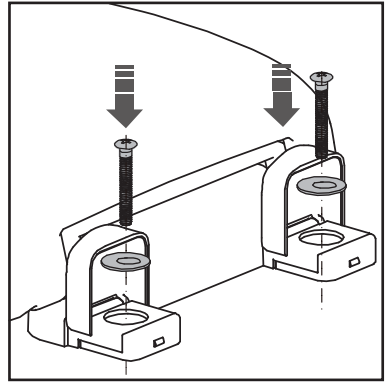

Slip the bolts through the washers, then through the hinge holes.

3

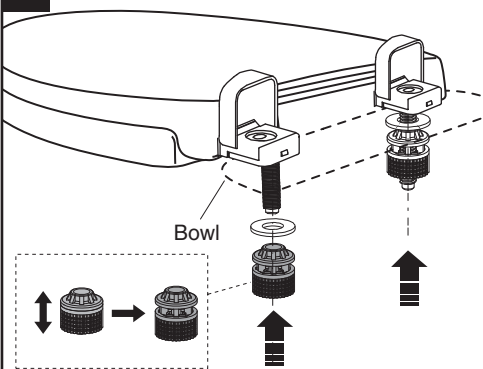

When opened, nuts can slip over threads for rapid installation.

4

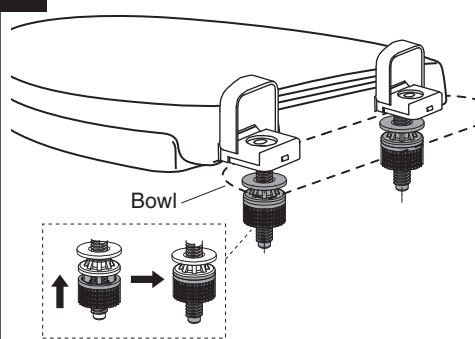

When closed, nuts lock onto threads, allowing final tightening with screwdriver or supplied attachment handles.

5

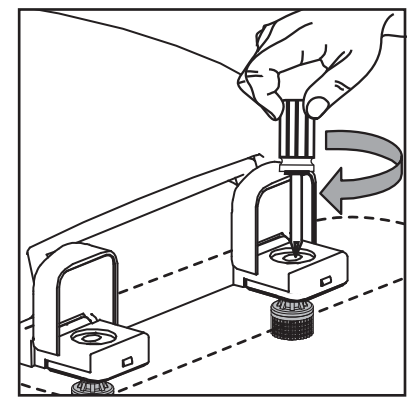

Tighten the bolts using a screwdriver. DO NOT OVERTIGHTEN.

6

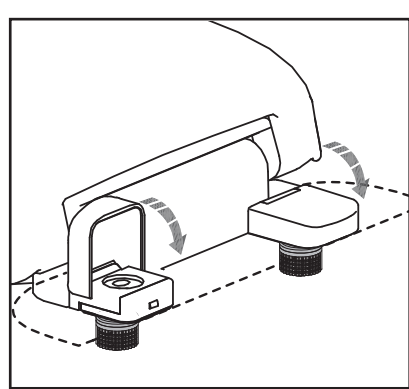

Close the hinge covers. The seat will not work if the hinge covers are not closed tightly.

7

## REMOVAL

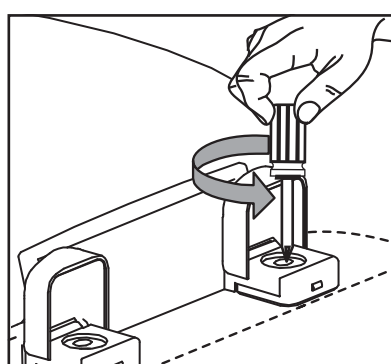

Unscrew with screwdriver or supplied attachment handles until bolt is loose.

8

## REMOVAL

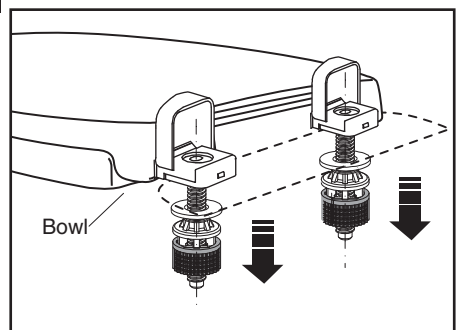

9

## REMOVAL

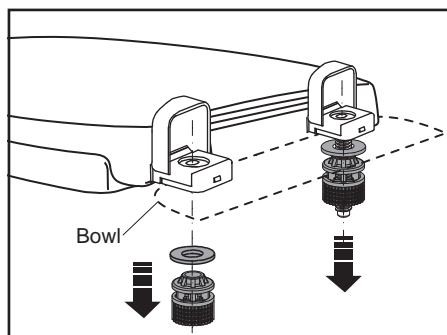

10

## REMOVAL

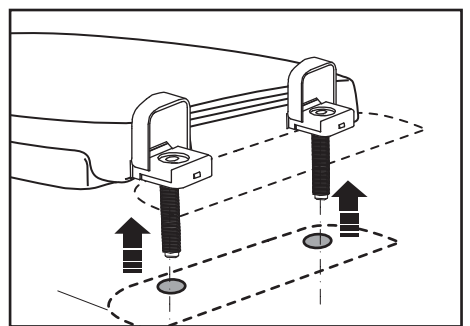

# TOP MOUNT TOILET SEAT

**NOTE: Pictures may not exactly depict toilet seat and components.**

**1**

## Grommet

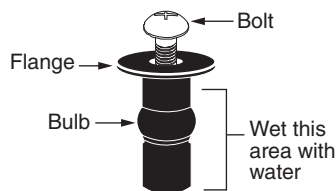

For ease of installation of black rubber grommets, insert steel bolt (capture a few threads), and wet the lower area with some water (soapy water works best).

**2**

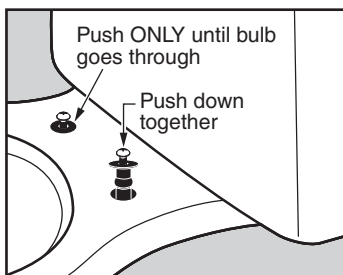

**NOTE: FLANGE MUST REMAIN ABOVE THE SURFACE.  
DO NOT ALLOW GROMMET TO FALL THROUGH!**

**3**

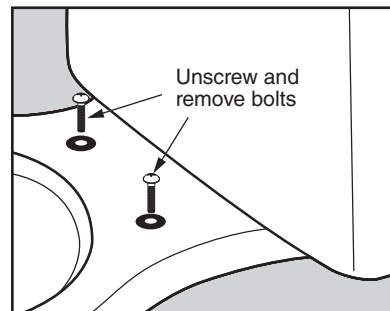

Once grommet is in place, unscrew and remove bolts and keep nearby for step 5.

**4**

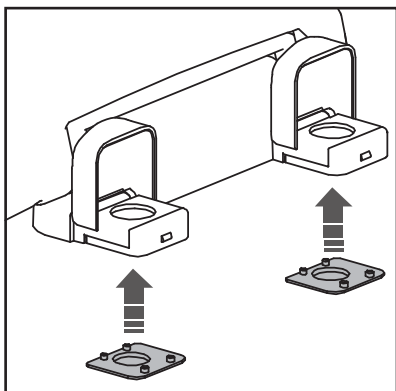

Install rubber base to seat post hinges.

**5**

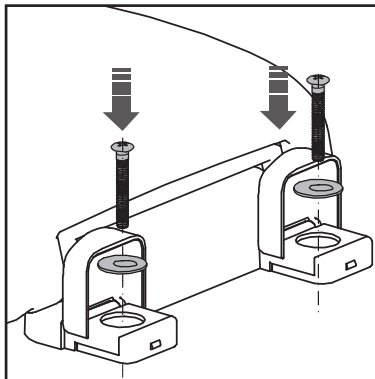

Slip the bolts through the washers, then through the hinge holes.

**6**

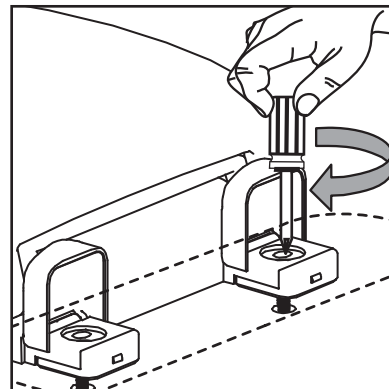

Tighten the bolts using a screwdriver. **DO NOT OVERTIGHTEN.**

**7**

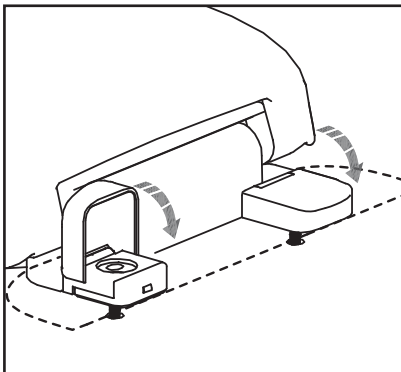

Close the hinge covers. The seat will not work if the hinge covers are not closed tightly.

## CARE AND CLEANING

When cleaning your toilet seat wash it with a mild, soapy water: rinse the seat thoroughly with clear water and dry with a soft cloth.

Avoid detergents, disinfectants, or cleaning products in aerosol cans. Never use abrasive scouring powders on your seat. Some bathroom chemicals and cosmetics may damage the seat's finish. After installation, check the tightness of the bolts from time to time to ensure a tight fit.

### In the United States:

American Standard Brands  
P.O. Box 6820  
Piscataway, New Jersey 08855  
Attention: Director of Customer Care  
For residents of the United States, warranty information may also be obtained by calling the following toll free number: (800) 442-1902  
[www.americanstandard.com](http://www.americanstandard.com)

### In Canada:

AS Canada, ULC  
5900 Avebury Rd.  
Mississauga, Ontario  
Canada L5R 3M3  
Toll Free: (800) 387-0369  
[www.americanstandard.ca](http://www.americanstandard.ca)

### In Mexico:

American Standard B&K Mexico  
S. de R.L. de C.V.  
Via Morelos #330  
Col. Santa Clara  
Ecatepec 55540 Edo. Mexico  
Toll Free: 01-800-839-1200  
[www.americanstandard.com.mx](http://www.americanstandard.com.mx)