

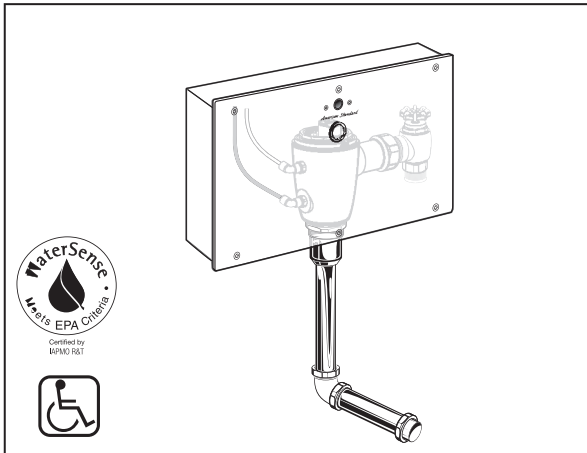

## SELECTRONIC® SENSOR OPERATED, CONCEALED URINAL FLUSH VALVE, 0.5 GPF WITH WALL BOX, BACK SPUD



### GENERAL DESCRIPTION:

Concealed, Sensor Operated Selectronic® Flush Valve (Front Access) for 3/4" back spud urinal.

### PRODUCT FEATURES:

- **Pressure Compensation** feature ensures accurate flush volume regardless of inlet water pressure
- **Self-Cleaning Piston** with integral wiper spring significantly reduces clogging and maintenance.
- **Selectronic® Proximity System** with universal sensor provides hygienic, "hands free" operation
- **State-of-the-Art Electronics** prevent ghost flushing
- **Dezincification Resistant** semi-red brass alloy
- **Fully Mechanical Manual Override Button** can flush the valve without power
- **Fail-Safe:** Valve automatically closes upon loss of power or water pressure and does not need to be reset
- **Adjustable Sanitary Flush** cleans the fixture & maintains the trap seal.
- **Stadium Feature:** Valve automatically switches to water savings mode during periods of heavy usage
- **Chemical resistant EPDM Seals** for extended life
- **Adjustable tailpiece** for rough-in flexibility
- **Can be installed left or right handed**
- **All exposed parts are chrome-plated**

### INCLUDES:

- 3/4" I.P.S. angle stop with back-flow protection and hand wheel
- 3/4" Sweat solder adapter
- 3/4" Vacuum breaker with spud coupling and flange

### MODEL NUMBER:

- ❑ **6063.515.007 DC Powered, 0.5 gpf**  
CR-P2 lithium battery included

#### FRONT ACCESS

Fully Mechanical Manual Override  
Vandal-Resistant Stainless Steel Wall Box

- ❑ **6062.505.007 Plug-In AC Powered, 0.5 gpf**  
**SAME AS ABOVE**  
Class 2 UL certified plug-in AC power supply included.  
Universal input voltage: 100 - 240 VAC, 50/60 Hz.

- ❑ **6061.505.007 Multi-AC Powered, 0.5 gpf**  
**SAME AS ABOVE**  
10' Extension cable and Y-connector included  
One transformer can power up to 15 faucets and/or flush valves in a daisy chain configuration.  
**POWER SUPPLY NOT INCLUDED**

### OPERATING PRESSURE:

25 psi (flowing) - 80 psi (static)

### FLOW REQUIREMENT:

10 gpm (37.9 L/min.)

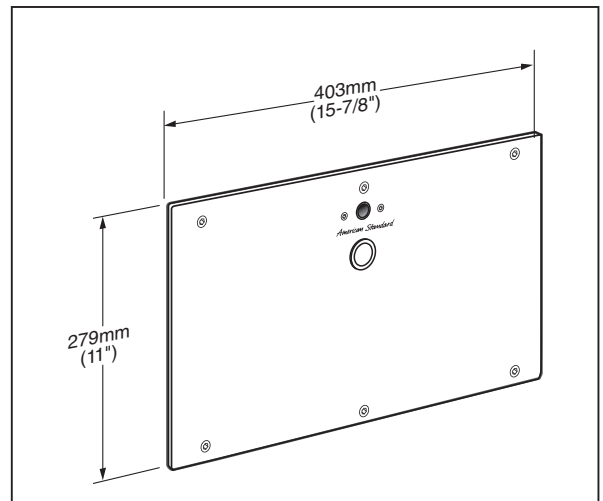

### RECOMMENDED SPECIFICATION:

Electronic, sensor activated flush valve for 3/4" back spud urinal shall feature self-cleaning piston valve with integral wiperspring in refill orifice to prevent clogging. Shall feature a fully mechanical manual override that can flush the valve without power. Shall also feature a semi-red brass valve body and vandal-resistant stainless steel wall box that includes the sensor and manual override button. Includes angle stop with back-flow protection and hand wheel. Sweat solder adapter and vacuum breaker also included. Must be installed and maintained from the front. 0.5 gpf / 1.9 Lpf. Flush Valve shall be American Standard Model # 606\_5\_5.007.

**LISTINGS:**

- ASSE 1037
- ANSI/ASME A112.19.2
- ADA Compliant

**Roughing-in Dimensions**

\*Note: The Critical Line (-C-L-) on Vacuum Breaker must typically be 6" (152mm) min. above fixture. Consult Codes for details.

**CAUTION:** Use only American Standard supplied cable sets. Using non-AS supplied cables, or cutting, splicing or modifying any components will void the warranty.

