

4175.201 Shown

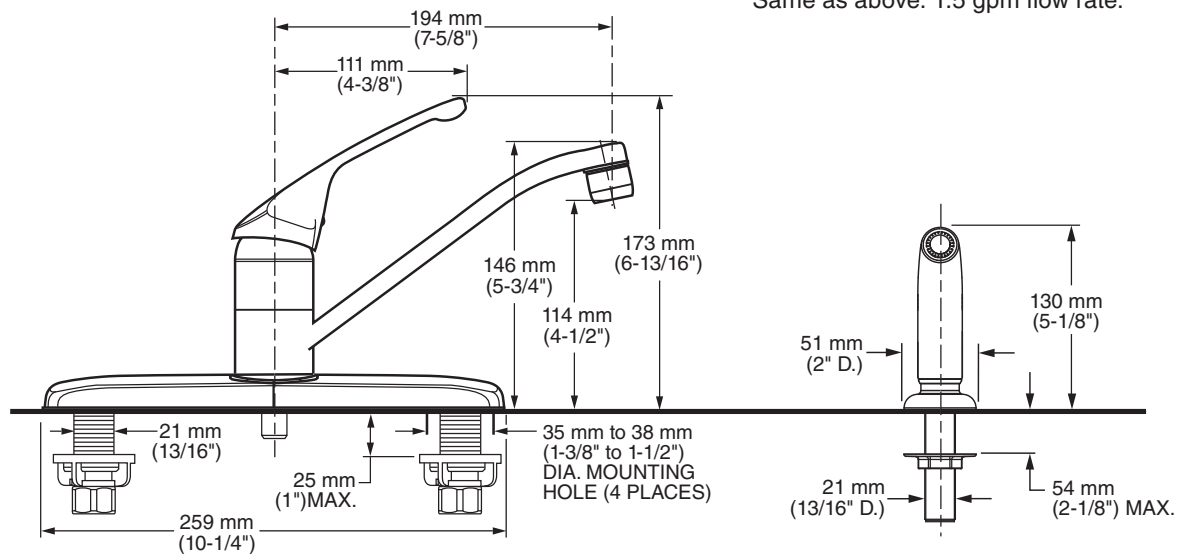

GENERAL DESCRIPTION:

Brass 7-5/8" (194 mm) swivel spout (360° rotation). Metal lever handle. Washerless 40mm ceramic disc valve cartridge. Cast brass waterway with 1/2" male inlet shanks. Metal escutcheon plate (escutcheon size 10-1/4"L x 2-3/8"W). 2.2 gpm/8.3 L/min. maximum flow rate, 1.5 gpm/5.7 L/min. maximum flow rate for F15 models.

PRODUCT FEATURES:

Ceramic Disc Valve Cartridge: Assures a lifetime of drip-free performance.

Cast Brass Waterways with "City Shanks": Strong and durable. Integral tabs on casting provide a wobble-free installation.

Memory Position Valving: Allows user to turn valve on and off at preferred temperature setting without readjusting handle position each time.

Lead Free: Faucet contains ≤ 0.25% total lead content by weighted average.

Large "Comfort Zone": Allows easy fine tuning of temperature.

Simple Installation: Fast and easy one person installation. Faucet drops in from top. Quick-spin nuts secure faucet in place.

SUGGESTED SPECIFICATION

Single control kitchen faucet shall feature cast brass waterway. Shall also feature washerless 40mm ceramic disc valve cartridge. Cast brass swivel spout. Fitting shall be American Standard Model # 4175.....



COLONY SOFT® SINGLE CONTROL KITCHEN FAUCET

CODES AND STANDARDS

These products meet or exceed the following codes and standards:

ANSI A117.1
ASME A112.18.1
NSF 61/Section 9 and Annex G
CSA B125.1

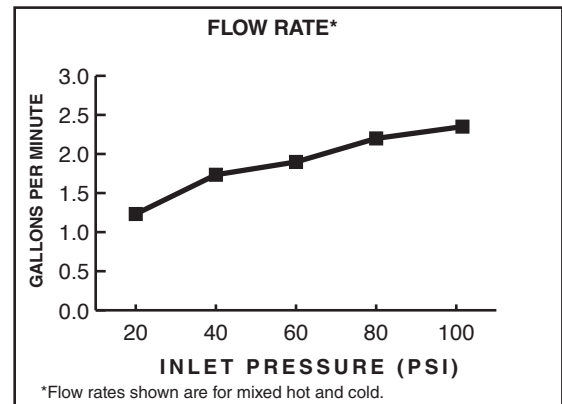

2.2 gpm/8.3 L/min. FLOW RATE

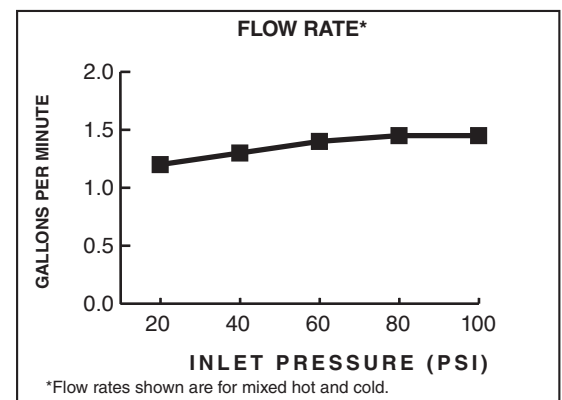

1.5 gpm/5.7 L/min. FLOW RATE

Product Number	Description	Finish
		Polished Chrome
		002
4175.201	Kitchen Faucet. Separate color-matched handspray.	
4175.201.F15	Same as above. 1.5 gpm/5.7 L/min. flow rate.	
4175.203	Kitchen Faucet. Separate color-matched handspray through escutcheon.	
4175.203.F15	Same as above. 1.5 gpm/5.7 L/min. flow rate.	
4175.200	Kitchen Faucet. LESS handspray.	
4175.200.F15	Same as above. 1.5 gpm/5.7 L/min. flow rate.	



Meets the American Disabilities Act Guidelines and **ANSI A117.1** Requirements for the physically challenged.