

**7573.140 Shown**

**MODEL NUMBER:**

- ☐ **7573.140 Laundry Faucet**  
Hose end. Lever handles.
- ☐ **7573.240 Laundry Faucet**  
Aerator. Lever handles.
- ☐ **7573.240.F15 Laundry Faucet**  
Aerator. Lever handles.

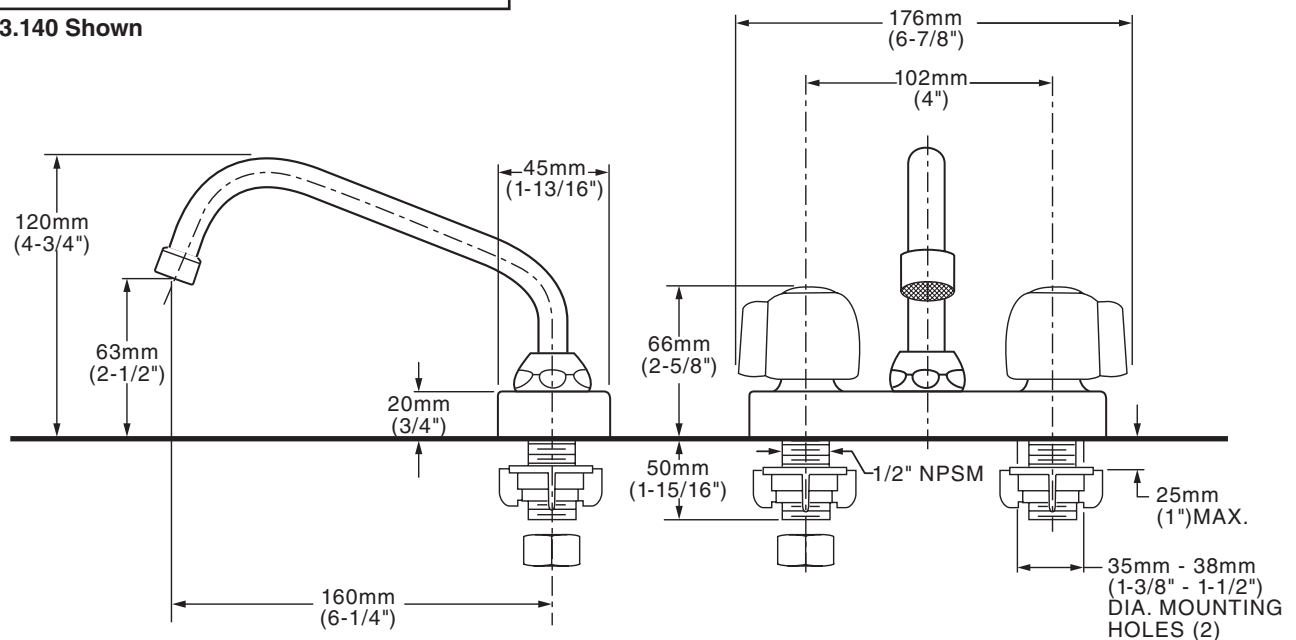

**GENERAL DESCRIPTION:**

4" centerset laundry faucet 1/4 turn washerless ceramic disc valve cartridges. Cast brass construction. 1/2" male threaded inlet shanks with brass coupling nuts. Brass swivel spout (360° rotation). Available with hose end or aerator with 2.2 gpm/8.3 L/min. maximum flow rate, 1.5 gpm/5.7 L/min. maximum flow rate for F15 models.

**PRODUCT FEATURES:**

**Ceramic Disc Valve Cartridges:** Assures a lifetime of drip-free performance.

**Solid Brass Construction:** Durable. Ideal for prolonged contact with water.

**Low Lead:** Meets NSF Standard 61/Section 9 & Prop 65 lead requirements.

**Choice of Spout End:** Hose end or Aerator.

**SUGGESTED SPECIFICATION:**

Two-handle centerset laundry sink faucet shall be brass construction with brass inlet shanks and coupling nuts. Shall also feature 1/4 turn washerless ceramic disc valve cartridges. Fitting shall be American Standard Model # 7573.\_\_\_\_.

## CODES AND STANDARDS

These products meet or exceed the following codes and standards:

**ASME A112.18.1**  
**CSA B 125**

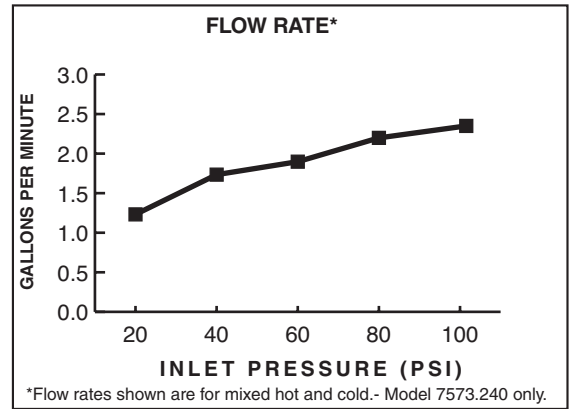

**2.2gpm/8.3L/min. FLOW RATE**

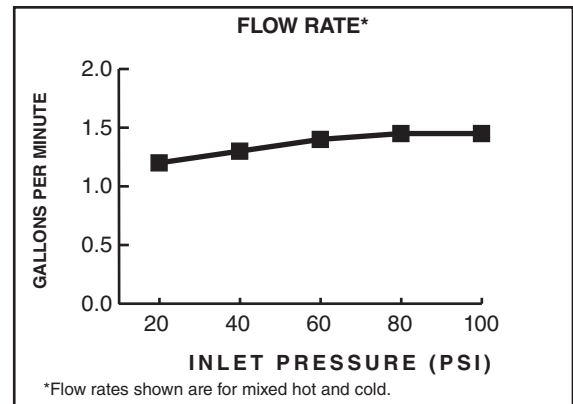

**1.5 gpm/5.7 L/min. FLOW RATE**

Product Number	Description	Finish
		Polished Chrome
		002
7573.140	Laundry Faucet. Hose End. Lever handles - 2.2 gpm/8.3 L/min. maximum flow rate	
7573.240	Laundry Faucet. Aerator. Lever handles - 2.2 gpm/8.3 L/min. maximum flow rate	
7573.240.F15	Laundry Faucet. Aerator. Lever handles - 1.5 gpm/5.7 L/min. maximum flow rate	