

# PARTS

## Ultima™ Selectronic® AC Powered Toilet Flush Valve, Piston-Type – 606B361 / 606B321 / 606B311 / 606B362 / 606B322 606B312

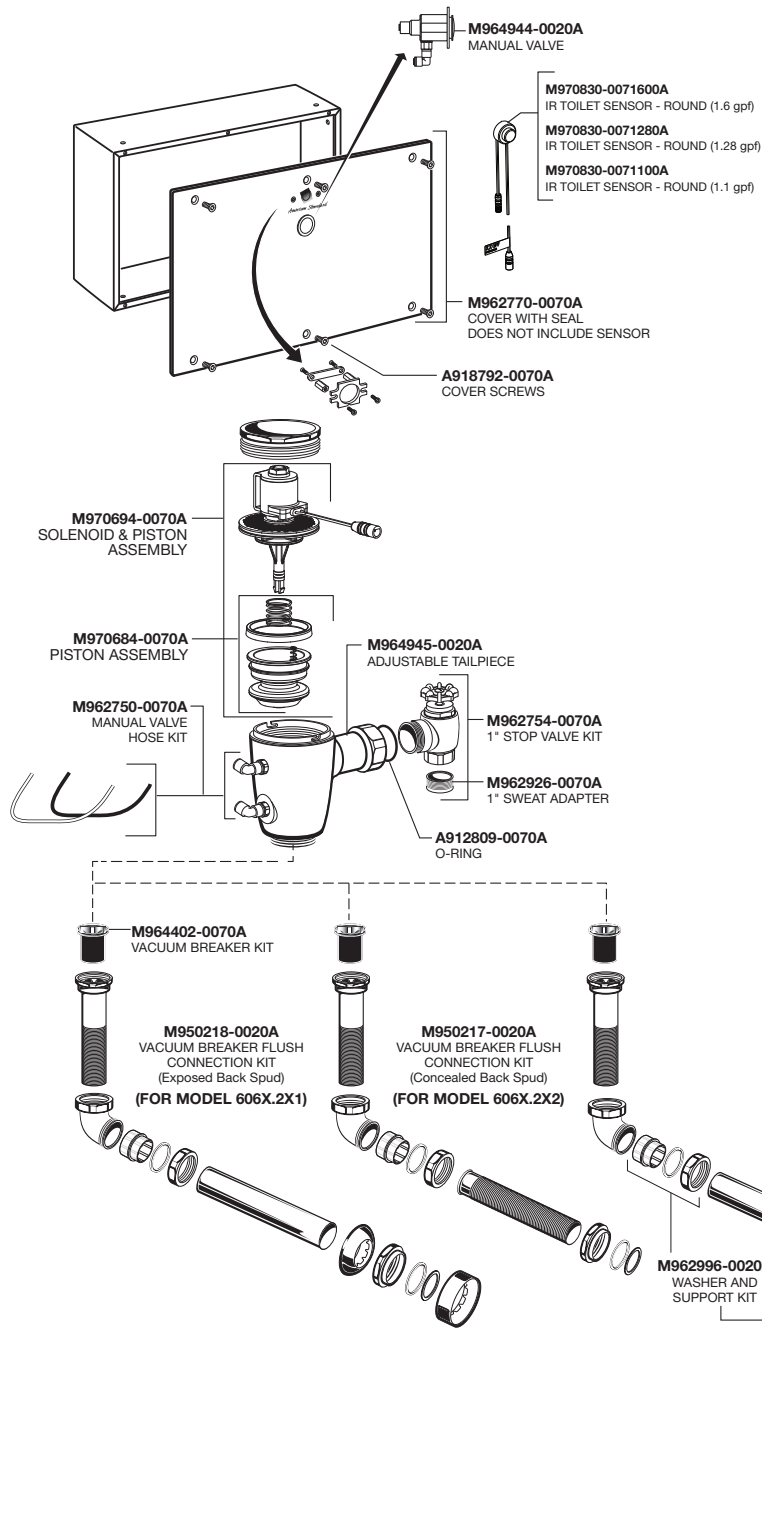

### PWRX Power Kit PK00.WRK

**M950360-0070A**  
CONNECTOR  
LOCKING  
DEVICE

**M950361-0070A**  
PWRX BATTERY PACK

### CR-P2 Battery Power Kit PK00-CRP

**M950360-0070A**  
CONNECTOR  
LOCKING DEVICE

**A923654-0070A**  
BATTERY 6V CR-P2

**M950514-0070A**  
BATTERY HOLDER

### Plug-In AC PK01.PAC

**M950360-0070A**  
CONNECTOR  
LOCKING  
DEVICE

**M950338-0070A**  
POWER SUPPLY

### Hard-Wired AC PK01.HAC

**M950360-0070A**  
CONNECTOR  
LOCKING  
DEVICE

**M950527-0070A**  
POWER SUPPLY

### Multi-AC Power Kit PK01.MAC

**M950216-0020A**  
VACUUM BREAKER FLUSH  
CONNECTION KIT  
(Top Spud)  
(FOR MODEL 606X.2X3)

# PIÈCES

## Ultima,<sup>MC</sup> Selectronic<sup>MD</sup> l'alimentation A C robinet de chasse de toilette, à piston – 606B361 / 606B321 / 606B311 / 606B362 606B322 / 606B312

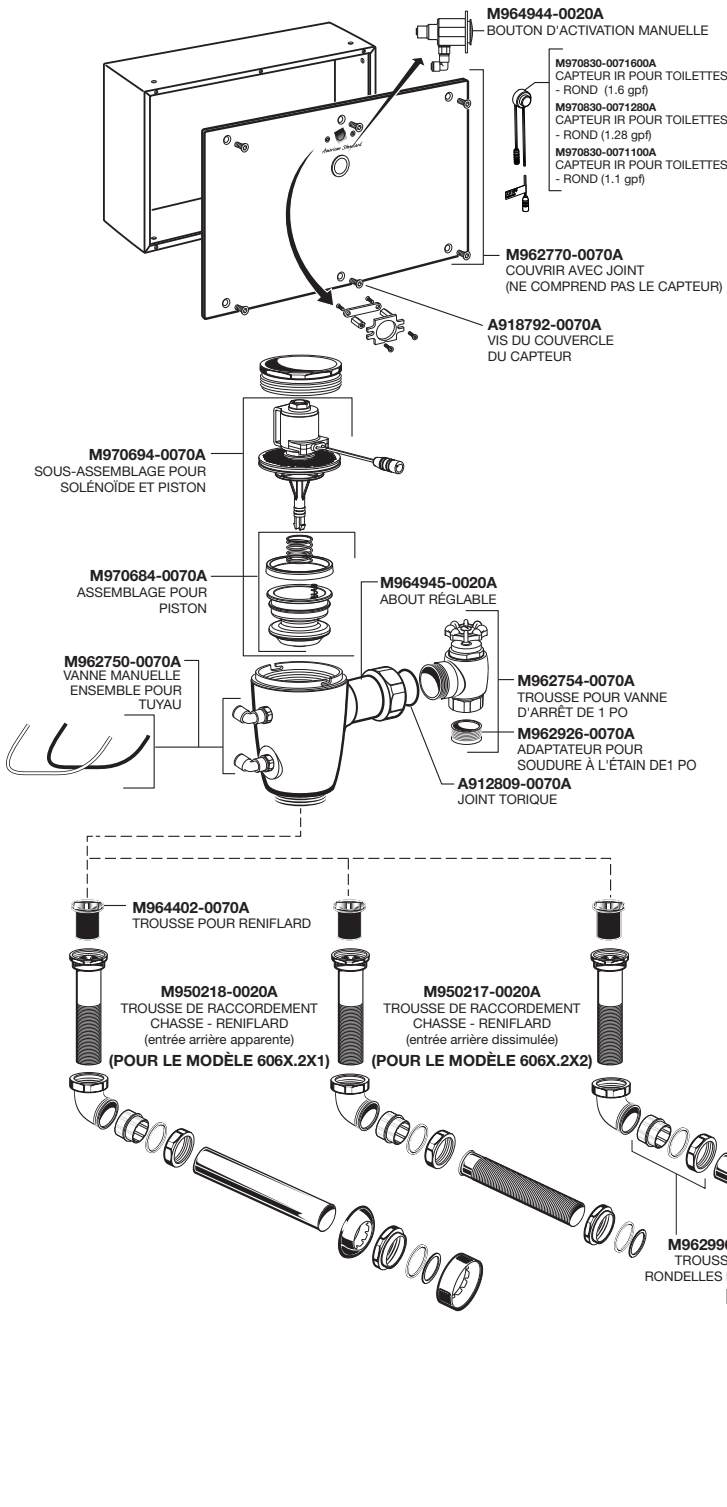

### Ensemble d'alimentation PK00.WRK



### Pile CR-P2 au lithium PK00-CRP



### Ensemble d'alimentation par branchement C.A. PK01.PAC



### Ensemble d'alimentation en C.A. fixe PK01.HAC

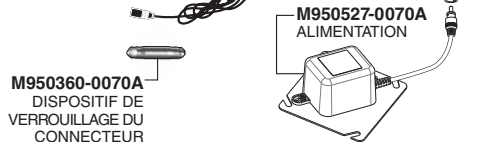

### Ensemble d'alimentation par multi C.A. PK01.MAC



# PIEZAS

## Ultima™ Alimentado por CA Selectronic® Válvula de descarga del inodoro, pistón – 606B361 / 606B321 / 606B311 / 606B362 606B322 / 606B312

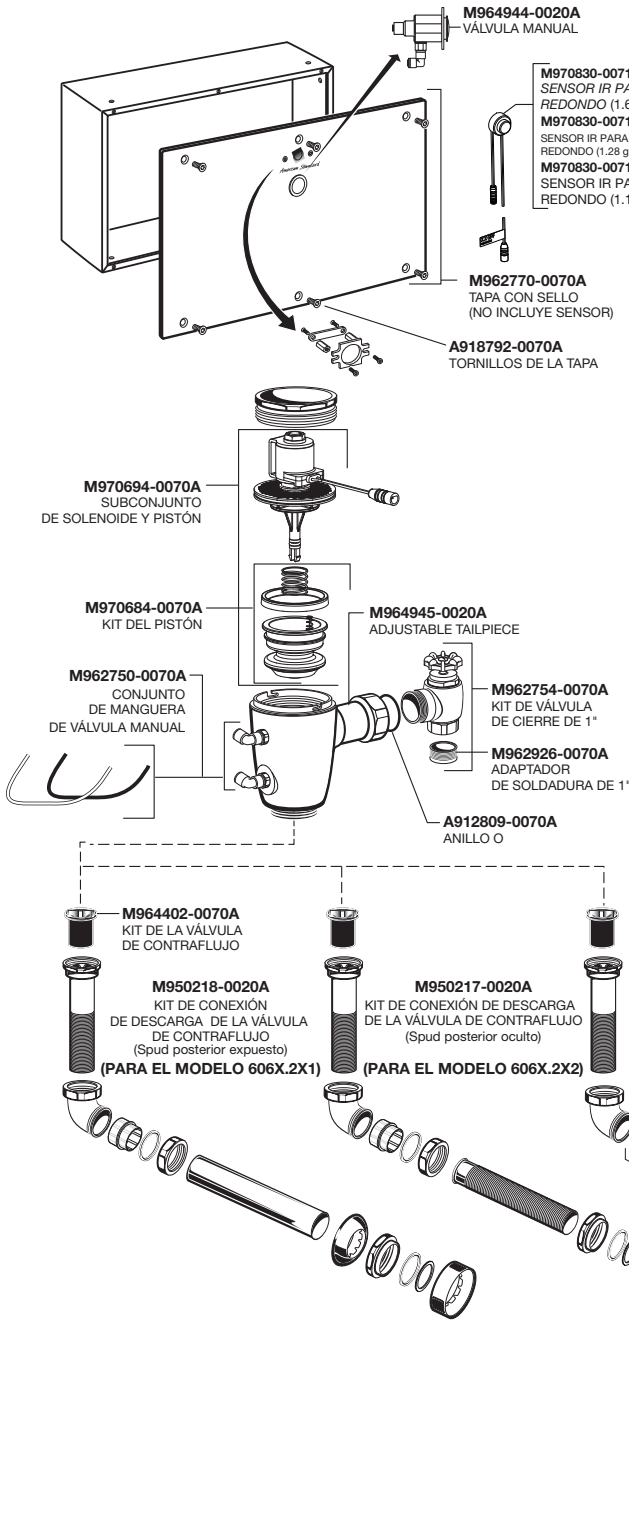

### Kit de electricidad PK00.WRK



### Batería de litio CR-P2 PK00-CRP

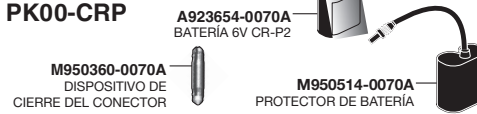

### Kit de electricidad Enchufe AC PK01.PAC



### Kit de electricidad Cableado AC PK01.HAC

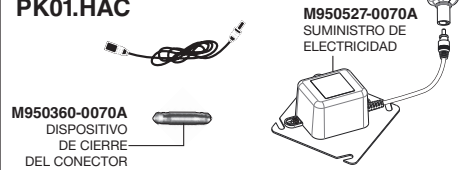

### Kit de electricidad Multi AC PK01.MAC

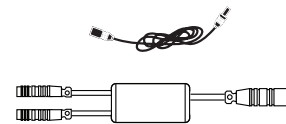

RP\_606B3XX SP 4/25

Los nombres de producto mencionados en este documento son marcas de comercio de AS America, Inc. © AS America, Inc. 2024

PART OF LIXIL

American Standard