

**MightyTuff™ SL Series  
Toilet Seat with Ever-Tite®**

- ☐ **5267A60CL** Elongated toilet seat
- ☐ **5267B60CL** Round Front toilet seat

- **No Slam** soft close seat and lid
- Lift to Release and Quick Connect hinges for fast installation and easy removal for cleaning
- **Ever-Tite®** locking system, engineered to reduce movement
- Molded in seat bumpers to **Minimize Flex** on the hinge
- **Crush Resistant** lid design holds up to 300lbs.
- Adjustable seat positioning to accommodate a range of toilet bowls
- Produced from virgin polypropylene plastic
- UV protection to prevent discoloring or fading of the finish
- Includes bottom mount hardware with **Quick Connect Nut** for a speedier installation



SHOWN: SLOW CLOSE FEATURE



**AVAILABLE SPARE PARTS**  
**Mounting kit - 760408-100.0070A**

To Be Specified

- ☐ Color:
  - ☐ White
  - ☐ Bone



1. Open the hinge  
cover



2. Pull the seat



3. Removed

SHOWN: EASY REMOVAL FEATURE

SEE REVERSE FOR ROUGHING-IN DIMENSIONS  
AND PRODUCT SPECIFICATIONS



EASY  
LIFT-OFF  
SEAT



SLOW-  
CLOSE  
SEAT

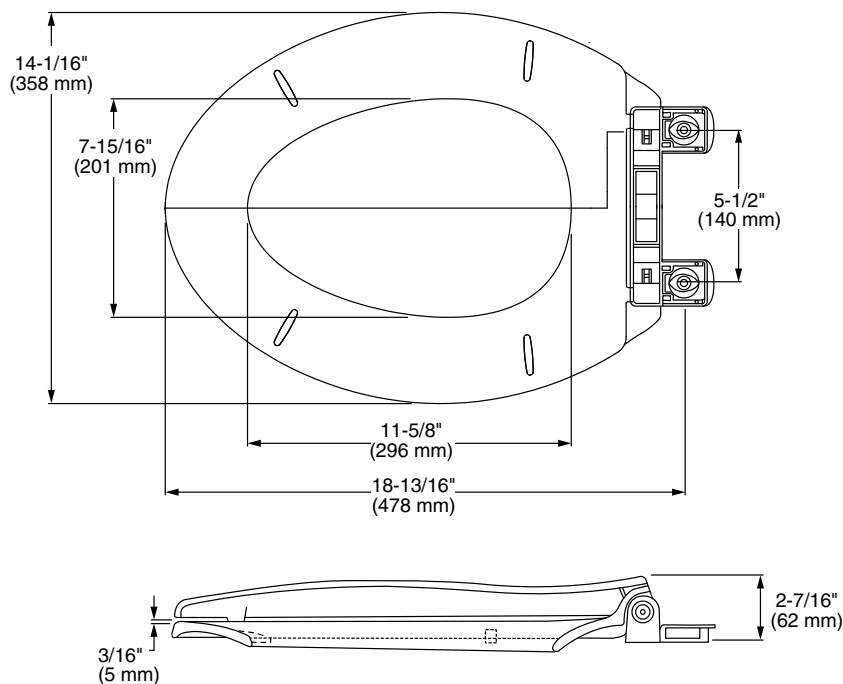

**5267A.60CL Elongated Toilet Seat**

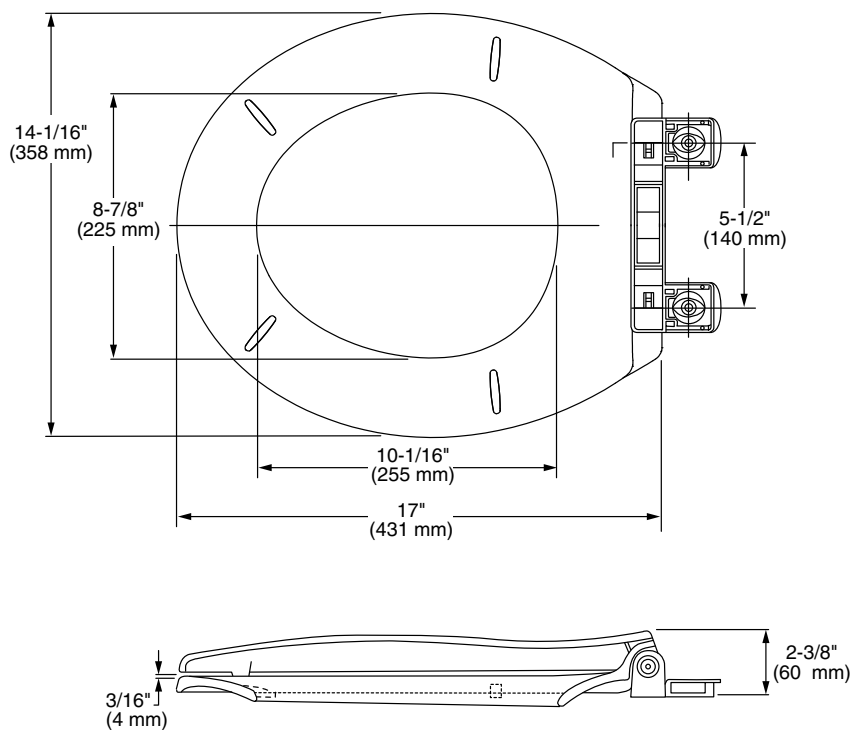

**5267B.60CL Round Front Toilet Seat**