

American Standard

Installation Instructions for 1594.170 TOWN SQUARE Series

TRIP-LEVER BATH WASTE and OVERFLOW
WITH POP-UP DRAIN

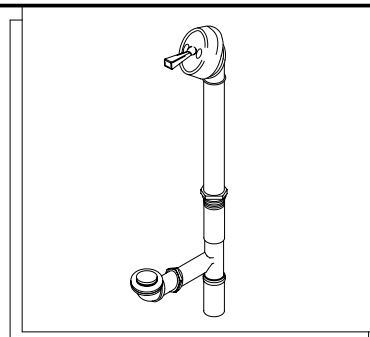

U.S. Patent No. 4,294,289 Other Patents Pend.



EXPLODED VIEW OF DRAIN

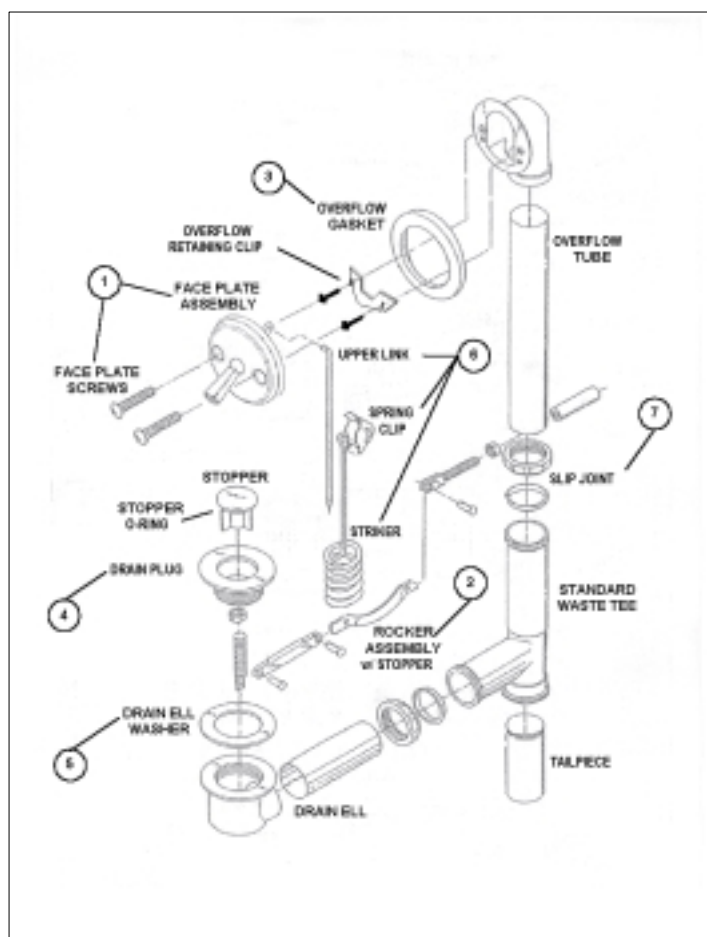

1. Assemble the WASTE TEE, DRAIN ELL, TAILPIECE, OVERFLOW tube & GASKET, SLIP JOINTS and DRAIN PLUG to the bath. It may be necessary to cut the OVERFLOW tube and DRAIN ELL tube for proper fit.

2. Select the STOPPER and slide the O-RING into the groove. Thread the STOPPER onto the ROCKER Assembly and slip it into the DRAIN PLUG.

3. Adjust the LINKAGE length. Slide the LINKAGE/FACE PLATE assembly into the OVERFLOW. The bottom of the striker must rest on the ROCKER assembly. Operate trip lever on drain to check for proper operation.

4. Assemble OVERFLOW RETAINING CLIP using (2) #10 screws in lower holes of overflow elbow. Tighten snugly. (Do Not Over-Tighten)

5. Align the holes in the FACE PLATE with those in the OVERFLOW TUBE. Tighten SCREWS snugly (do not over tighten). The OVERFLOW GASKET (behind tub wall) will begin to seal as the FACE PLATE becomes tighter. The OVERFLOW GASKET can be rotated for desired fit to bath.

6. Adjust the STOPPER on the ROCKER assembly so that the STOPPER rises approximately 3/8" in the open position. When you are satisfied with the overall fit of the drain, tighten all joints and check for leaks.

REPAIR PARTS LISTED ON PAGE 2

OVERFLOW GASKET CAN
BE ROTATED TO FIT BATH

CUT-AWAY VIEW OF DRAIN

NEED HELP?

CALL 1-800-223-0068 OPTION 4 then OPTION 2

WEEKDAYS: 8:00 a.m. to 8:00 p.m. Eastern Time

SATURDAYS: 8:00 a.m. to 2:00 p.m.

SUNDAYS: 10:00 a.m. to 2:00 p.m.

APPLY THREAD SEALANT
ON TAILPIECE THREADS
BEFORE ASSEMBLY.

SEALANT
BETWEEN TUB WALL
AND DRAIN PLUG

TUB WALL

Repair Parts Listing

Item No.	Part Number	Quantity	Description
1	753135-YYY0A*	1	Face Plate w/ Screws
2	753136-YYY0A*	1	Rocker Assembly with Stopper
3	752126-YYY0A*	1	Drain Plug
4	753137-0070A	1	Overflow Gasket w/Retaining Clip
5	751977-100	1	Drain Ell Washer, Rubber
6	752384-0070A	1	1594.170 Linkage Kit Only
7	066483-0070A	1	Slip Joint Kit

* REPAIR PART / ASSEMBLY ONLY - YYY INDICATES FINISH: 099 POL. BRASS, 295 SATIN, 002 CHROME