

7075100 Shown

MODEL NUMBER:

- ☐ **7075100 Single Control Lavatory**
Metal lever handle. Metal pop-up drain.
- ☐ **7075102 Single Control Lavatory**
Metal lever handle. 50/50 Pop-up drain.
- ☐ **7075104 Single Control Lavatory**
Metal lever handle. LESS drain.
LESS pop-up rod & hole.

AVAILABLE ACCESSORY:

- ☐ **2000102P Escutcheon Plate Only**

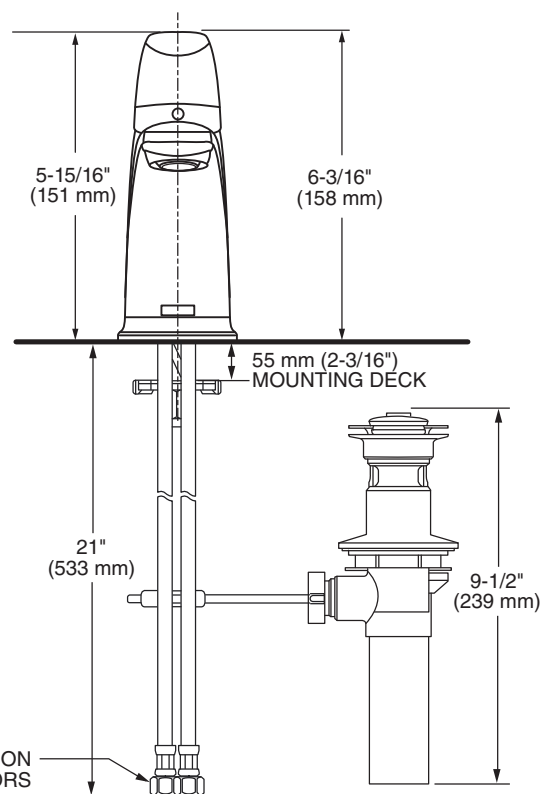
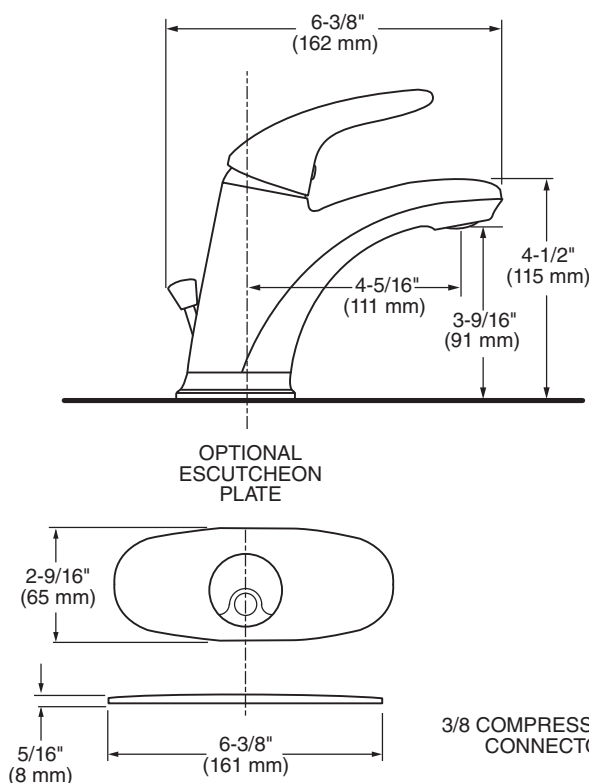

GENERAL DESCRIPTION:

Metal body. Washerless 35 mm ceramic disc valve cartridge with integral hot limit safety stop. 24" color-coded braided flexible supply hoses with 3/8" compression connectors. 1.2 gpm/4.5 L/min. maximum flow rate. Fitting can be mounted on 4" centers using optional escutcheon (2000102P) or single hole mounting method.

PRODUCT FEATURES:

Ceramic Disc Valve Cartridge: Assures a lifetime of smooth handle operation and drip-free performance.

Adjustable Hot Limit Safety Stop: Limits the amount of hot water allowed to mix with cold. Reduces the risk of accidental scalding.

Lead Free: Faucet contains $\leq 0.25\%$ total lead content by weighted average.

Anti-Vandal Aerator

SUGGESTED SPECIFICATION

Single control lavatory faucet shall feature a metal body and metal lever handle. Shall also feature washerless ceramic disc valve cartridge with integrated hot limit safety stop. Fitting shall be American Standard Model # 707510X._____.

CODES AND STANDARDS

These products meet or exceed the following codes and standards:

- ANSI A117.1
- ASME A112.18.1
- CSA B125.1
- NSF/ANSI/CAN 61: Q≤1
- NSF/ANSI/CAN 372

CEC

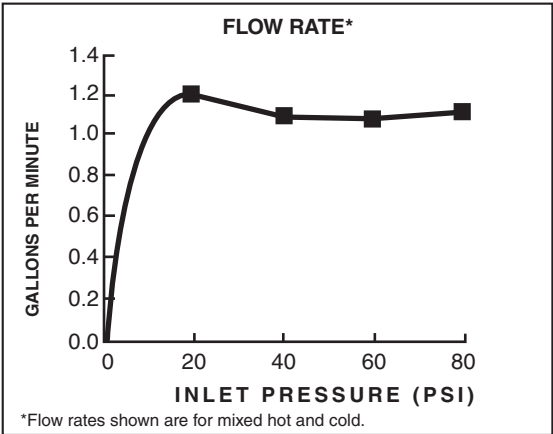

Product Number	Description		Finish Options			
			Polished Chrome	Legacy Bronze	Brushed Nickel	Matte Black
			002	278	295	243
7075100	Colony PRO Single Control Lavatory Faucet. Metal lever handle. Metal pop-up drain.	ADA	✓	✓	✓	✓
7075102	Colony PRO Single Control Lavatory Faucet. Metal lever handle. 50/50 Pop-up drain.	ADA	✓	✓	✓	
7075104	Colony PRO Single Control Lavatory Faucet. Metal lever handle. LESS drain. LESS pop-up hole & rod.	ADA	✓	✓	✓	✓
7075102P	Optional Escutcheon Plate Only (For mounting on 4" centers).		✓	✓	✓	✓

ADA Meets the American Disabilities Act Guidelines and ANSI A117.1 Requirements for the physically challenged.